

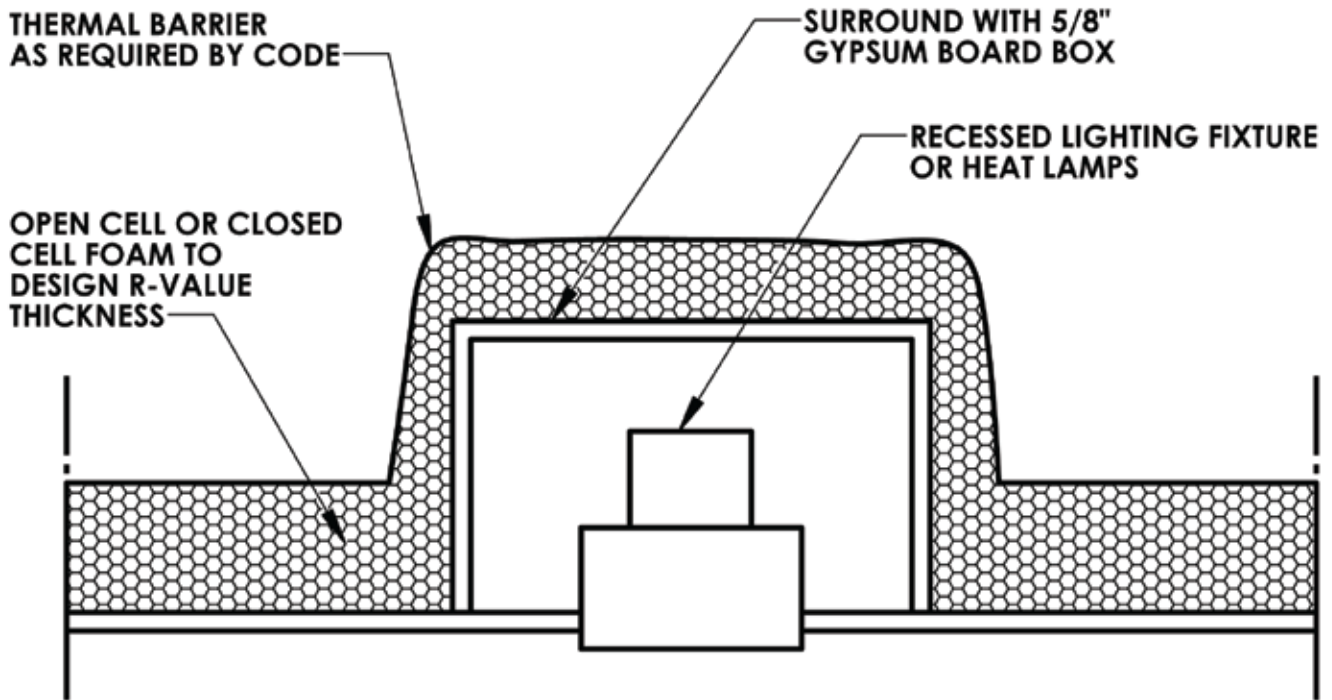

Ceiling Recessed Light



NOTES:

- 1) INSULATING FOAM MUST BE SEPARATED FROM RECESSED LIGHTS BY 2"
- 2) INSULATING FOAM MUST BE SEPARATED FROM FIREPLACE FLUES BY 3"

Lapolla Industries Inc.
15402 Vantage Parkway East, Suite 322
Houston, Texas 77032
1-888-4-LAPOLLA
Lapolla.com